

Section II.

TM 9-2320-280-24P-1

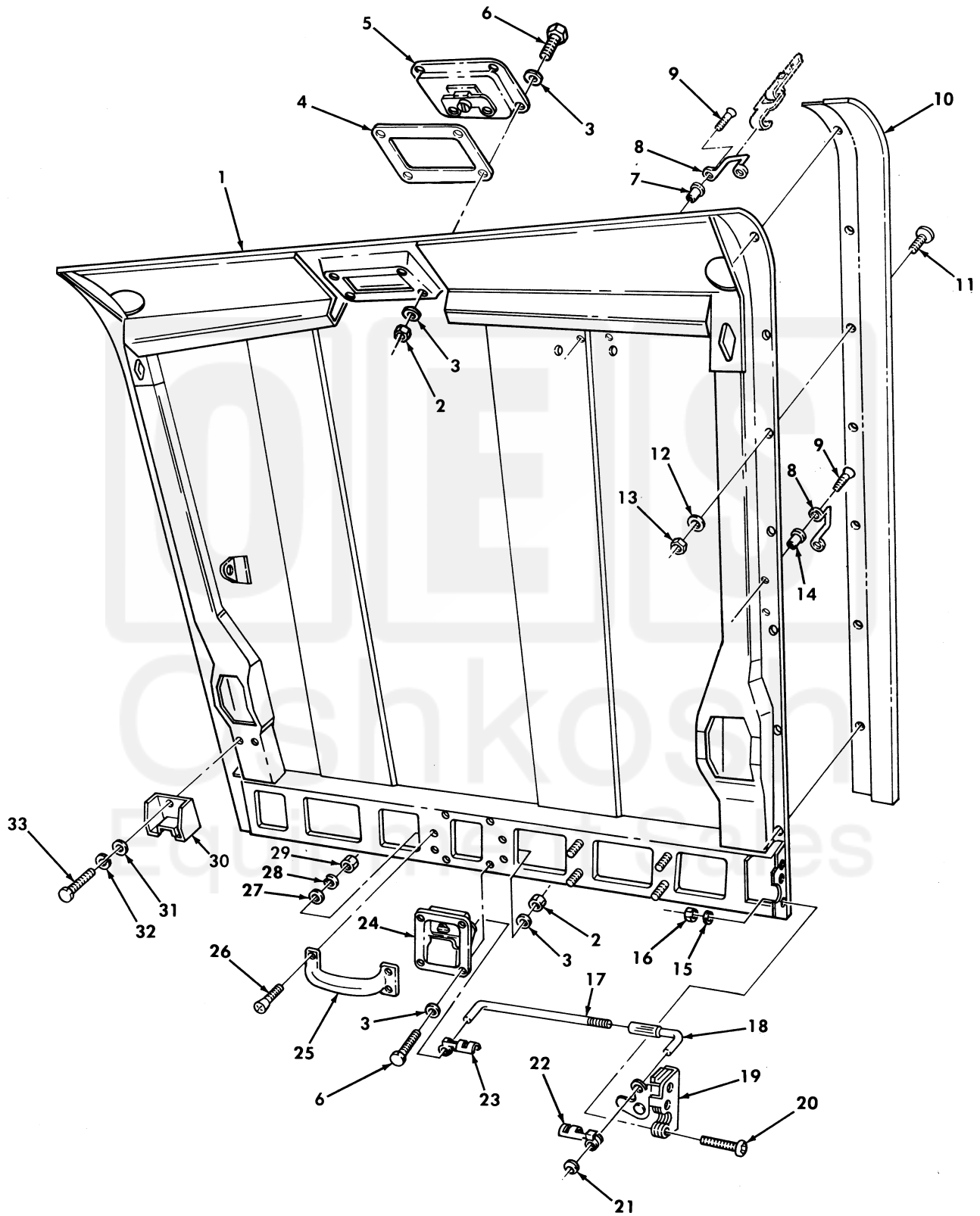

Figure 269. Cargo Shell Door Assembly, Basic and Supplemental Armor.

Current part is item (23) on diagram. Available at www.oshkoshequipment.com

SECTION II		TM9-2320-280-24P				
(1)	(2)	(3)	(4)	(5)	(6)	(7)
ITEM NO	SMR CODE	NSN	CAGEC	PART NUMBER	DESCRIPTION AND USABLE ON CODES(UC)	QTY
GROUP 1812 SPECIAL PURPOSE BODIES						
FIG. 269 CARGO SHELL DOOR ASSEMBLY, BASIC AND SUPPLEMENTAL ARMOR						
1	XAOZZ		34623	5574377	DOOR ASSEMBLY..... UC:A11,H11,MMM	1
1	XAOZZ		34623	5584358	DOOR ASSEMBLY..... UC:B17,B18,H17,H18	1
1	XAOZZ		34623	5595228	DOOR ASSEMBLY..... UC:A24,A27,B24,H24,H27	1
1	XAOZZ		19207	12446912	DOOR ASSEMBLY..... UC:B25	1
1	XAOZZ		19207	12446908	DOOR ASSEMBLY..... UC:C17	1
1	XAOZZ		34623	5595227	DOOR ASSEMBLY..... UC:A25,A26,H25,H26	1
2	PAOZZ	5310009349758	96906	MS35649-202	NUT,PLAIN,HEXAGON..... UC:A11,A24,A25,A26,A27,B17,B18,B24, B25,C17,H11,H17,H18,H24,H25,H26,H27, MMM	8
3	PAOZZ	5310012349416	96906	MS51412-2	WASHER,FLAT #10..... UC:A11,A24,A25,A26,A27,B17,B18,B24, B25,C17,H11,H17,H18,H24,H25,H26,H27, MMM	16
4	PAOZZ	5330014583810	19207	12341348	GASKET..... UC:A11,A24,A25,A26,A27,B17,B18,B24, B25,C17,H11,H17,H18,H24,H25,H26,H27, MMM	1
5	PAOZZ	5340012597601	19220	38-5611-UL	CATCH,FLUSH..... UC:A11,A24,A25,A26,A27,B17,B18,B24, B25,C17,H11,H17,H18,H24,H25,H26,H27, MMM	1
6	PAOZZ	5305011858674	7X677	9421294	SCREW,CAP,HEXAGON H #10-24 X 1/2... UC:A11,A24,A25,A26,A27,B17,B18,B24, B25,C17,H11,H17,H18,H24,H25,H26,H27, MMM	8
7	PAOZZ	5325014110066	78276	ALS4-1024-130	INSERT,SCREW THREAD..... UC:B25	40
7	PAOZZ	5325014110066	78276	ALS4-1024-130	INSERT,SCREW THREAD..... UC:C17	38
8	PAOZZ	5340004895684	19220	6411B	LOOP,STRAP FASTENER..... UC:B25,C17	20
9	PAOZZ	5305014108386	24617	156966	SCREW,MACHINE..... UC:B25,C17	40
10	PFOZZ	2540011924504	19207	12339646-1	SHIELD,DEFLECTOR,MI L.H..... UC:A11,A24,A27,B24,H11,H24,H27,MMM	1
10	PFOZZ	2540011929721	19207	12339646-2	SHIELD,DEFLECTOR,BL R.H..... UC:A11,A24,A27,B24,H11,H24,H27,MMM	1
11	PAOZZ	5305000680502	96906	MS90725-6	SCREW,CAP,HEXAGON H 1/4-20 X .75... UC:A11,A24,A27,B24,H11,H24,H27,MMM	26
12	PAOZZ	5310011023270	24617	2436161	WASHER,FLAT 1/4..... UC:A11,A24,A27,B24,H11,H24,H27,MMM	26

Current part is item (23) on diagram. Available at www.oshkoshequipment.com

Current part is item (23) on diagram. Available at www.oshkoshequipment.com

SECTION II		TM9-2320-280-24P					
(1)	(2)	(3)	(4)	(5)	(6)	(7)	
ITEM NO	SMR CODE	NSN	CAGEC	PART NUMBER	DESCRIPTION AND USABLE ON CODES(UOC)	QTY	
13	PAOZZ	5310000614650	96906	MS51943-31	NUT, SELF-LOCKING, HE 1/4-20.....	26	
					UOC:A11, A24, A27, B24, H11, H24, H27, MMM		
14	PAOZZ		78276	ALS4-1024-225	INSERT, SCREW THREAD.....	2	
					UOC:C17		
15	PAOZZ	5310004079566	96906	MS35338-45	WASHER, LOCK 5/16.....	12	
					UOC:A11, A24, A25, A26, A27, B17, B18, B24, B25, C17, H11, H17, H18, H24, H25, H26, H27, MMM		
16	PAOZZ	5310008140673	96906	MS51943-33	NUT, SELF-LOCKING, HE 5/16-18.....	12	
					UOC:A11, A24, A25, A26, A27, B17, B18, B24, B25, C17, H11, H17, H18, H24, H25, H26, H27, MMM		
17	PAOZZ	5306011950277	34623	5583141	BOLT, HOOK.....	4	
					UOC:A11, A24, A25, A26, A27, B17, B18, B24, B25, C17, H11, H17, H18, H24, H25, H26, H27, MMM		
18	PAOZZ	5340011972736	19220	16386(75)	ROD END, THREADED.....	4	
					UOC:A11, A24, A25, A26, A27, B17, B18, B24, B25, C17, H11, H17, H18, H24, H25, H26, H27, MMM		
19	PAOZZ	5340011996103	19220	3-400-R	LATCH, DOOR R. H. FRONT, LEFT REAR.....	2	
					UOC:A11, A24, A25, A26, A27, B17, B18, B24, B25, C17, H11, H17, H18, H24, H25, H26, H27, MMM		
19	PAOZZ	5340011985455	19220	3-400-L (25)	PLATE, MOUNTING LATCH, DOOR L.H. FRONT & R.H. REAR.....	2	
					UOC:A11, A24, A25, A26, A27, B17, B18, B24, B25, C17, H11, H17, H18, H24, H25, H26, H27, MMM		
20	PAOZZ	5305002264831	80204	B1821BH031C150N	SCREW, CAP, HEXAGON H 5/16-18 X 1.50.	12	
					UOC:A11, A24, A25, A26, A27, B17, B18, B24, B25, C17, H11, H17, H18, H24, H25, H26, H27, MMM		
21	PAOZZ	5310012131333	78553	C183-012-4	PUSH ON NUT.....	8	
					UOC:A11, A24, A25, A26, A27, B17, B18, B24, B25, C17, H11, H17, H18, H24, H25, H26, H27, MMM		
22	PAOZZ	5340011958837	78947	HS49745	CLIP, RETAINING R. H.....	4	
					UOC:A11, A24, A25, A26, A27, B17, B18, B24, B25, C17, H11, H17, H18, H24, H25, H26, H27, MMM		
23	PAOZZ	5340011968158	78947	HS49746	CLIP-CLEVIS, ROD RET L.H.....	4	
					UOC:A11, A24, A25, A26, A27, B17, B18, B24, B25, C17, H11, H17, H18, H24, H25, H26, H27, MMM		
24	PAOZZ	5340012598600	19220	34-4974-51X	CATCH, FLUSH.....	1	
					UOC:A11, A24, A25, A26, A27, B17, B18, B24, B25, C17, H11, H17, H18, H24, H25, H26, H27, MMM		
25	PFOZZ	5340011978239	14557	U-6236	HANDLE, BOW FRONT.....	1	
					UOC:A11, A24, A25, A26, A27, B17, B18, B24, B25, C17, H11, H17, H18, H24, H25, H26, H27, MMM		

Current part is item (23) on diagram. Available at www.oshkoshequipment.com

Current part is item (23) on diagram. Available at www.oshkoshequipment.com

SECTION II			TM9-2320-280-24P			
(1)	(2)	(3)	(4)	(5)	(6)	(7)
ITEM NO	SMR CODE	NSN	CAGEC	PART NUMBER	DESCRIPTION AND USABLE ON CODES(UC)	QTY
26	PAOZZ	5305012542453	34623	5592861	SCREW,MACHINE #12-24 X 3/4..... UOC:A11,A24,A25,A26,A27,B17,B18,B24, B25,C17,H11,H17,H18,H24,H25,H26,H27, MMM	4
27	PAOZZ	5310011023270	24617	2436161	WASHER,FLAT 1/4..... UOC:A11,A24,A25,A26,A27,B17,B18,B24, B25,C17,H11,H17,H18,H24,H25,H26,H27, MMM	4
28	PAOZZ	5310002857037	96906	MS122031	WASHER,LOCK #12..... UOC:A11,A24,A25,A26,A27,B17,B18,B24, B25,C17,H11,H17,H18,H24,H25,H26,H27, MMM	4
29	PAOZZ	5310012544258	34623	5593000	NUT,PLAIN,HEXAGON #12-24..... UOC:A11,A24,A25,A26,A27,B17,B18,B24, B25,C17,H11,H17,H18,H24,H25,H26,H27, MMM	4
30	PAOZZ	5342011945806	19207	12339579	BRACKET,DOVETOIL..... UOC:A11,A24,A25,A26,A27,B17,B18,B24, B25,C17,H11,H17,H18,H24,H25,H26,H27, MMM	1
31	PAOZZ	5310008094058	96906	MS27183-10	WASHER,FLAT 1/4..... UOC:A11,A24,A25,A26,A27,B17,B18,B24, B25,C17,H11,H17,H18,H24,H25,H26,H27, MMM	2
32	PAOZZ	5310005501130	96906	MS35333-40	WASHER,LOCK 1/4..... UOC:A11,A24,A25,A26,A27,B17,B18,B24, B25,C17,H11,H17,H18,H24,H25,H26,H27, MMM	2
33	PAOZZ	5305000680508	80204	B1821BH025C075N	SCREW,CAP,HEXAGON H 1/4-20 X 3/4... UOC:A11,A24,A25,A26,A27,B17,B18,B24, B25,C17,H11,H17,H18,H24,H25,H26,H27, MMM	2

END OF FIGURE

Current part is item (23) on diagram. Available at www.oshkoshequipment.com